

BIG KAISER



HIGH PERFORMANCE TOOLING SOLUTIONS
HYDRAULIC CHUCK for Swiss Type Automatic Lathes
2018-2019

HYDRAULIC CHUCK FOR SWISS TYPE AUTOMATIC LATHES

CLAMPING RANGE: \varnothing 4-8mm

High-precision cutting with HYDRAULIC CHUCK is achieved on an automatic lathe.

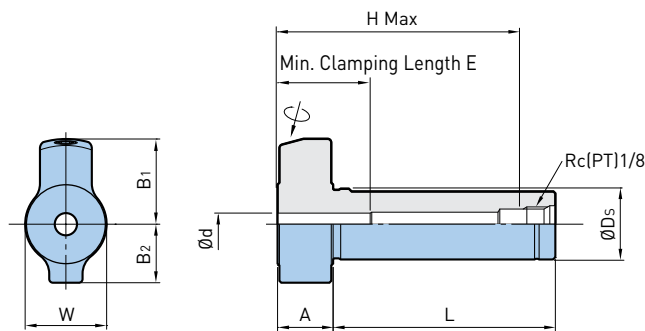

Catalog Number	Clamping Diameter $\varnothing d$	$\varnothing D_s$	L	A	B ₁	B ₂	W	H Max	E	Weight (lbs.)
SL19.05-HDC4-60	4mm	.750	2.36	.59	.91	.62	.87	2.56	.75	.4
-HDC6-60	6mm				.95				.98	.4
-HDC8-60	8mm				1.22				.3	
SL22-HDC4-70	4mm	22mm	2.75	.59	.91	.62	.98	2.95	.75	.5
-HDC6-70	6mm				.95				.98	.5
-HDC8-70	8mm				1.22				.5	

• Adjusting Screw cannot be used

CAUTION

Use only cutting tools that have a shank tolerance of h6. Do not use with cutting tools made with a flat on the shank (ie: Weldon type shank). Do not tighten the clamping screw without first inserting a cutting tool into the tool holder. Always insert the cutting tool into the hydraulic tool holder beyond min. clamping length "E".

BIG KAISER Precision Tooling Inc.

A Member of the BIG DAISHOWA Group

2600 Huntington Blvd | Hoffman Estates, IL 60192 | P: (224) 770-2999 | F: (224) 770-2997 | bigkaiser@us.bigkaiser.com | www.bigkaiser.com