

KAISER

309-1

EWB-UP

Highest Precision and Performance

- **Setting accuracy $\leq .00005''$**
- **Integrated balancing mechanism**



PRECISION BORING HEADS EWB-UP, SERIES 309

PEAK PERFORMANCE AND PRECISION UNIQUELY COMBINED

The revolutionary new EWB-UP series sets new standards for boring head adjustment accuracy and balance quality.

Diameter adjustments in the sub-micron range and balance qualities of G 6.3 are requirements for tight tolerance bores with maximum RPM's.



Insert holders are included with EWB-UP boring heads.

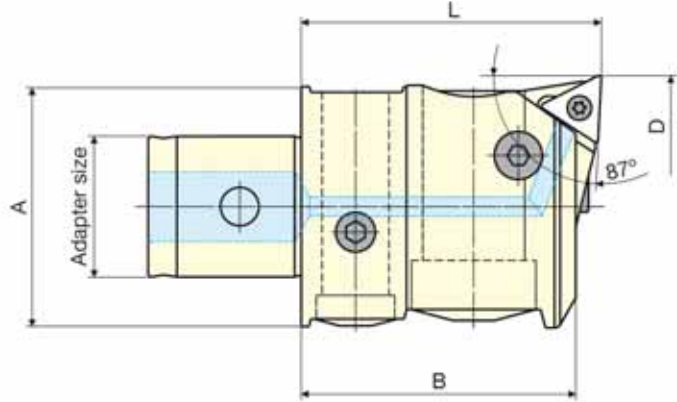

INCH GRADUATED HEADS, 1 DIV = .00005"/Ø

HEAD TYPE	ADAPTER SIZE	CATALOG NUMBER	BORING RANGE D		A	B	L	INSERT TYPE
			MIN	MAX				
EWB25UP	KA2	10.309.211	0.984	1.299	1.280	1.358	1.398	TP07
EWB32UP	KA3	10.309.311	1.260	1.654	1.181	1.457	1.575	TC11
EWB41UP	KA4	10.309.411	1.614	2.126	1.496	1.693	1.850	TC11
EWB53UP	KA5	10.309.511	2.087	2.756	1.929	2.087	2.244	TC11
EWB68UP	KA6	10.309.611	2.677	3.937	2.520	2.646	2.795	TC11

METRIC GRADUATED HEADS, 1 DIV = .001mm/Ø

HEAD TYPE	ADAPTER SIZE	CATALOG NUMBER	BORING RANGE D		A	B	L	INSERT TYPE
			MIN	MAX				
EWB25UP	KA2	10.309.201	25	33	23.4	32.5	35.5	TP07
EWB32UP	KA3	10.309.301	32	42	30.0	37.0	40.0	TC11
EWB41UP	KA4	10.309.401	41	54	38.0	43.0	47.0	TC11
EWB53UP	KA5	10.309.501	53	70	49.0	53.0	57.0	TC11
EWB68UP	KA6	10.309.601	68	100	64.0	67.2	71.0	TC11

Features:

- Ultra-precise diameter adjustment via rough adjustment of the insert holder and fine adjustment with dial scale. 1 DIV = .00005"/Ø (without vernier).
- Absolutely free from any movement with combined clamping of insert holders and tool carriers.
- High precision and fast balance adjustment, G 6.3 at 6,600 SFM, simply by setting the desired finish bore diameter on the balance scale.
- High quality coated tool body for complete protection from corrosion.
- Same tool lengths and boring ranges as with the standard EWN program.
- Max cutting speed is 6,600 SFM.

BIG KAISER[®]
PRECISION TOOLING INC.

641 Fargo Ave., Elk Grove Village, IL 60007
We are moving to a larger facility. Please use address below as of 11/09.
 2600 Huntington Blvd., Hoffman Estates, IL 60192
 Tel: 847.228.7660 • Fax: 847.228.0881
 web: www.bigkaiser.com • e-mail: bigkaiser@bigkaiser.com